

REVISIONS			
REV.	DESCRIPTION	BY	DATE
A	INITIAL RELEASE	MJP	03/21/2021

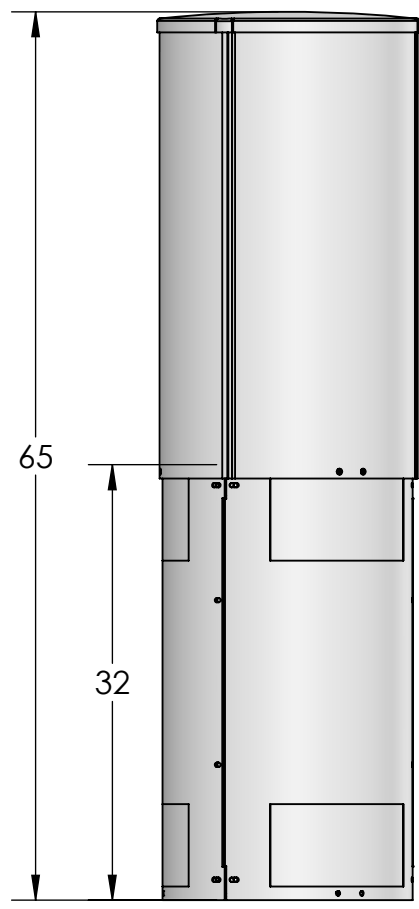
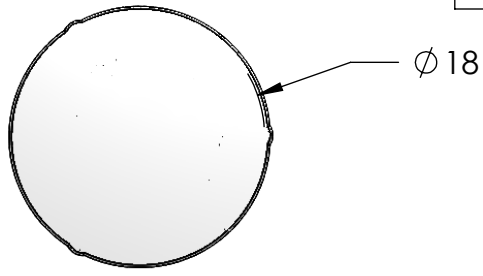

CANISTER ANTENNA
COSMETIC SHROUD

CANISTER ANTENNA

PT18 ENCLOSURE

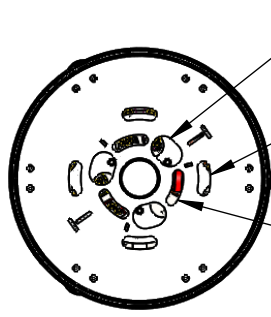
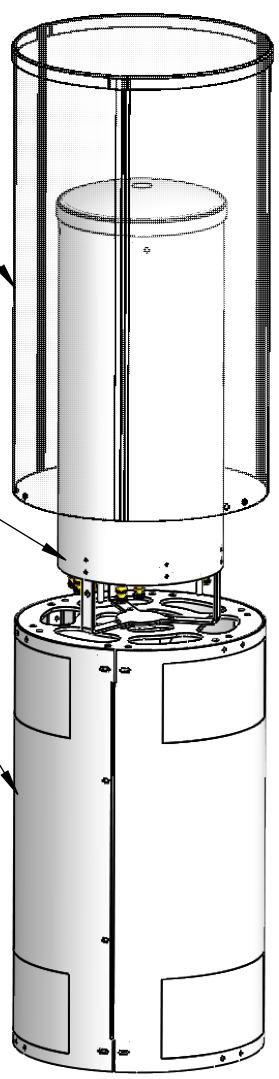

CABLE ROUTING
OPENINGS

(4) 3/4" MOUNTING BOLTS
EQUALLY SPACED ON Ø 9.5 B.C.

ADDITIONAL MOUNTING OPTIONS
(3) 5/8" MOUNTING BOLTS
EQUALLY SPACED ON Ø 5.62 B.C.

<p>These drawings and specifications are the proprietary property of CommScope Inc. and may be used only for the specific purpose authorized in writing by CommScope Inc.</p> <p>ALL DIMENSIONS ARE IN INCHES U.O.S. TOLERANCES UNLESS OTHERWISE SPECIFIED:</p> <p>.X = ± .12 ANGLES ±2° .XX = ± .06 FRACTIONS ±1/32 .XXX = ± .031</p> <p>REMOVE BURRS AND BREAK EDGES .005</p> <p>DO NOT SCALE THIS PRINT</p>	<p>DRAWN BY: MJP</p>	<p>SHEET: 1 of 1</p>	<p>PART NUMBER: SSC-760233122E1UX CUT SHEET</p>
	<p>CHECKED BY:</p>	<p>SCALE:</p>	<p>DESCRIPTION: METRO CELL, SOLN - PT 18 IN</p>
	<p>DATE:</p>	<p>MATERIAL: A36, A500, AL 5052</p>	<p>DRAWING TYPE:</p>
	<p>REVISION: A</p>	<p>FINISH: N/A</p>	<p>WEIGHT:</p>